

➔ Make whatever you please!  
Have fun!

So easy!  
**v. former**®

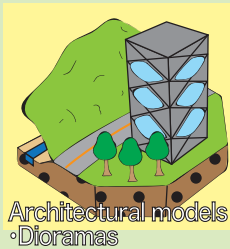

Architectural models  
• Dioramas

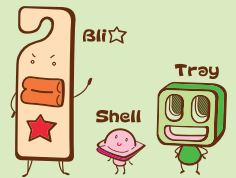

Original trays



3D objects for school



Original trays

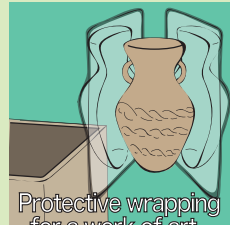

Protective wrapping  
for a work of art



The mold of  
a three-dimensional object



Catering dishes

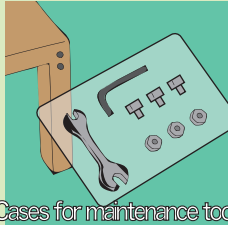

Cases for maintenance tools



Molds for originally  
shaped candles or soap

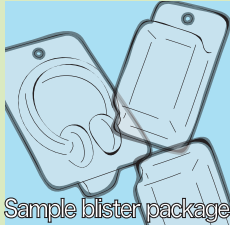

Sample blister packages



Toys

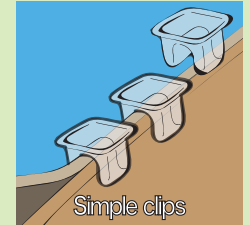

Simple clips

**1** Make various shapes out of clay.

This is how the V.Former works.

**2** Use V.Former.

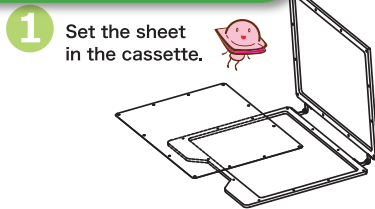
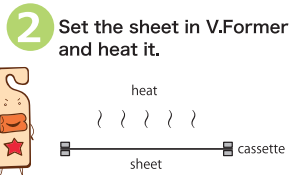

Place the sheet on the cassette and heat it.

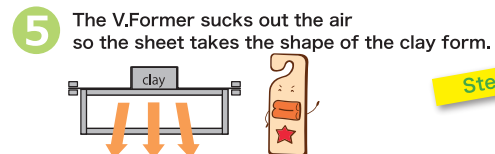
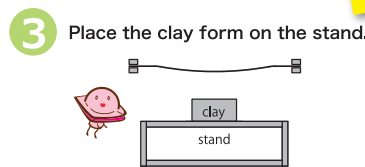
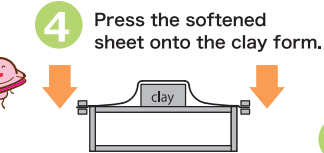

Take the cassette out of the V.Former and lift off the sheet.

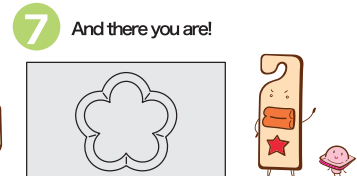
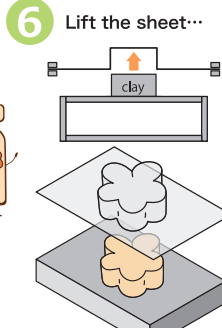

It's done. You can cut and color the sheet to make a display sign for an exhibition or many other things.

8 The sheet has become a mold to shape candles, cakes or other things.

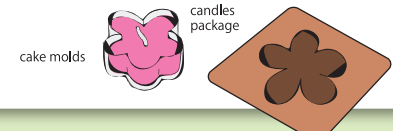

[V.Former Specifications]

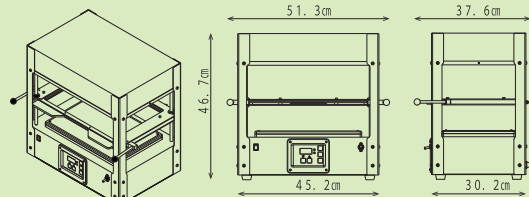

Power supply : 100V (50-60Hz)  
Load : 1100W  
Temperature settings : 50~300°C (\*1)  
Weight : 14.0Kg  
Form size : 325mm×218mm  
Usable sheet thickness : ~1.5mm (\*2)



v.formerl 検索

\*1 Set temperature: The V.Former heats from the bottom, so the temperature may not reach the temperature set.  
\*2 Usable sheet thickness: Sheets within the specified thickness may not work if bent, distorted or of uneven thickness.